



O2 Hydro Post Carbon Filter Installation, Use & Care Guide

Tools & Parts Included

- A. Mounting Bracket
- B. 20" Housing w/ Carbon Filter
- C. 1 Housing Lid
- D. Housing Wrench
- E. Silicone Grease
- F. 4 Lag Bolts
- G. 4 Wall Mount Screws
- H. 4 Washers

Tools Needed

- Level
- Pencil
- 1/2" Nut Driver
- 7/16" Nut Driver
- Adapters from home pipe size to 1"

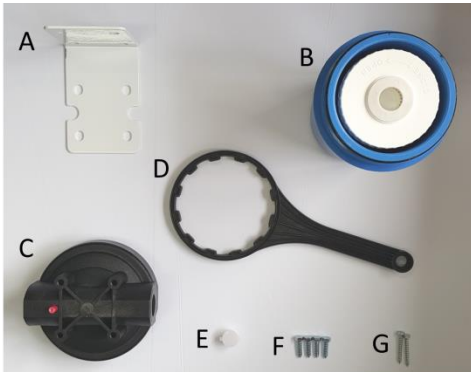

Installation Requirements

- Install the system on main water line entering your location to treat the water for all outlets. Do not use with water that is microbiologically unsafe or of unknown quality without adequate disinfection before or after the system.
- Install in a location that is not susceptible to freezing temperatures as damage to the housings can occur. Install away from direct sunlight as prolonged exposure to ultra violet light can weaken plastic components.
- System dimensions are 28" h x 7" w x 8" d.
- The system needs to be mounted to a solid surface for use and safety.
- If your water pressure exceeds 70 psi, a pressure regulator must be installed and set at 70 psi or less.
- An optional bypass with additional shutoff valve(s) is recommended for convenience when changing your filters or needing to preserve filter life when using outdoor irrigation.

SEE INSTRUCTIONS ON PAGE 4

For service, installation or to re-order Filters
visit www.hqhometek.com/solutions/water-solutions or call HydroCare 888-963-6178.

Installation Instructions

Use your mounting bracket, pencil and level to locate and mark your two wall mount locations. Unthread the housing lid from the housing and line it up from inlet to outlet, keeping the red pressure release button on the inlet side right or left (See Figure 1). The system can be set up left to right or right to left depending on the direction of the water's flow path. Mount the housing lid to the bracket with the lag bolts provided (See Figure 1). Mount the bracket to your marked location using the wall mount screws provided. After the main control head.



Figure 1

Connection Instructions

1. Attach water source to the inlet side.
2. Attach outlet side.
3. Remove the plastic wrappings from the filter and place in the housing.
4. Using your finger, lubricate the surface of the o-ring on the housing with silicone grease provided in cap (See Figure 4).
NOTE: *This step is important to ensure a proper housing seal.*
5. Thread housing onto its lid and hand-tighten. Use wrench to make snug.
6. See step (7) in the connection instructions.



Figure 4

Filter Replacement Guide

Filter Replacement Instructions

1. Turn off water supply or use bypass.
 2. Open a cold water faucet until water stops running. Leave faucet open.
 3. Press red pressure-relief buttons on top of each filter housing.
 4. Place a water receptacle under the unit. ie. A bucket or a pan.
 5. Use filter wrench, turning wrench to the left, to unscrew housing from lid (See Figure 1). Please note that they will weigh approximately 6-12 lbs. each.
 6. Remove bottom of housings by lowering straight down.
 7. Remove used filters from housings by placing your thumb in the center and your fingers on the outside of the insert (See Figure 2).
 8. Empty the water into your receptacle.
 9. Use a blunt edge. ie. butter knife or flathead screwdriver to remove large o-rings and wipe clean.
 10. Use your finger to liberally apply additional silicone grease provided to the surface of each o-ring. (See Figure 3).
- NOTE:** *This step is important to ensure a proper housing seal. Silicone is packaged in the small black plastic jar.*
11. Unpack the new filters and remove the plastic.
 12. Insert the new filters into the housings top up. The top is where the grommet is.
 13. The housings and their filters need to remain in line with your bracket, 1 through 3, inlet to outlet.
 14. Place housings, one at a time, level up to housing lids. Turn them to the right and hand tighten.
 15. Use filter wrench until snug.
 16. Slowly turn your main water feedback on until water returns to your open faucet.
 17. Check for leaks.
 18. If you do have a leak or a drip, repeat steps for applying silicon.